

ATTACHMENT A

# ATTACHMENT A

**IDENTIFICATION PLAN –  
DEPOSITED PLAN 880891**



EXECUTED BY THE CITY OF SYDNEY BY ITS  
 ATTORNEY SUZANNE PUCKERIDGE PURSUANT  
 TO POWER OF ATTORNEY REGISTERED NUMBER  
 603 BOOK 4174 IN THE PRESENCE OF

CITY OF SYDNEY

WITNESS  
 (NAME PRINTED)  
**HELEN DIMITROVSKI**

*Suzanne Puckeridge*  
 SUZANNE PUCKERIDGE

19/10/18

CONSENT OF SYDNEY CITY COUNCIL  
 TO THE DEFINITION OF GEORGE ST.  
 FURNISHED. *Shary*

Crown Lands Office Approval

PLAN APPROVED .....  
 Land District .....  
 Paper No .....  
 Field Book ..... pages

Council's Certificate

I hereby certify that -  
 (a) the requirements of the Local Government Act, 1919 (other  
 than the requirements for the registration of plans), and  
 (b) the requirements for the registration of plans, and  
 (c) the requirements for the registration of plans,  
 have been complied with by the applicant in relation to the  
 proposed ..... SUBDIVISION  
 (insert "new road", "subdivision" or "consolidated lot" set out herein  
 in full)

Date ..... 16 JULY 1998

Subdivision No ..... 371/1998

(Signature) *Suzanne Puckeridge*

Role ..... General Manager/Autonomous Person

Council File No ..... 522-2883

"This certificate is to be deleted where the application is only for  
 a consolidated lot or the opening of a new road or where the land to be  
 subdivided is wholly outside the area of operations of the Water  
 Board or the area of operations of the Water Corporation Ltd."

Where applicable

SURVEY PRACTICE REGULATION 1996 : CLAUSE 32(2)

MARK	I.S.G. CO-ORDINATES		ZONE	ACC	R.L.
	EASTING	NORTHING			
S.S.M. 71426	319284.566	1251731.911	56/1	3	6.356
P.M. 40097	319221.307	1251492.455	56/1	2	
P.M. 40115	319150.503	1251650.224	56/1	2	
P.M. 55231					

SOURCE: I.S.G. CO-ORDINATES ADOPTED FROM DEPT. OF CALM  
 AT 8-12-97  
 COMBINED SCALE FACTOR 0.999994



DP 8880891  
 Registered 20.10.1998  
 C.A. NO 27/1998 OF 24.7.1998  
 Title System: OLD SYSTEM  
 Purpose: SUBDIVISION  
 Ref. Map: U1945 - 1142  
 Last Plan: DP 565158  
 PLAN OF LOT 2  
 D.P. 565158 (FOR LEASE  
 PURPOSES)  
 SUBDIVISION OF  
 (BK 7187 LD 687 - CA 79080)  
 Lengths are in metres. Reduction Ratio: 1:200

LGA: SYDNEY  
 Suburb/Locality: SYDNEY  
 Parish: ST. PHILIP  
 County: CUMBERLAND

This is sheet 1 of my plan in...  
 (Benefit if applicable)  
 Sheets

T. TASY MORAITIS  
 of DENNY LINKER & CO DX 630 SYDNEY  
 a registered practitioner under the Surveyors Act 1998  
 certify that the survey represented in this plan is accurate. This plan  
 made in accordance with the Surveyors (Practitioner Regulation 1998  
 and was completed on 3.7.98  
 The survey referred to  
 (here specify the land actually surveyed or specify any other matter  
 in the plan that is not the subject of the survey)  
 (Signature) *T. Tasy Moraitis*  
 Datum: 'X' - Y  
 Zone: South Australian  
 Surveyor registered under  
 the Surveyors Act 1998  
 Plans used in preparation of survey/development:  
 D.P. 565158, 606885

PANEL FOR USE ONLY for statements of intention  
 to dedicate public roads, to create public reserves,  
 drainage reserves, easements, restrictions on the  
 use of land or positive covenants.

\*OFFICE USE ONLY

PLAN FORM 2

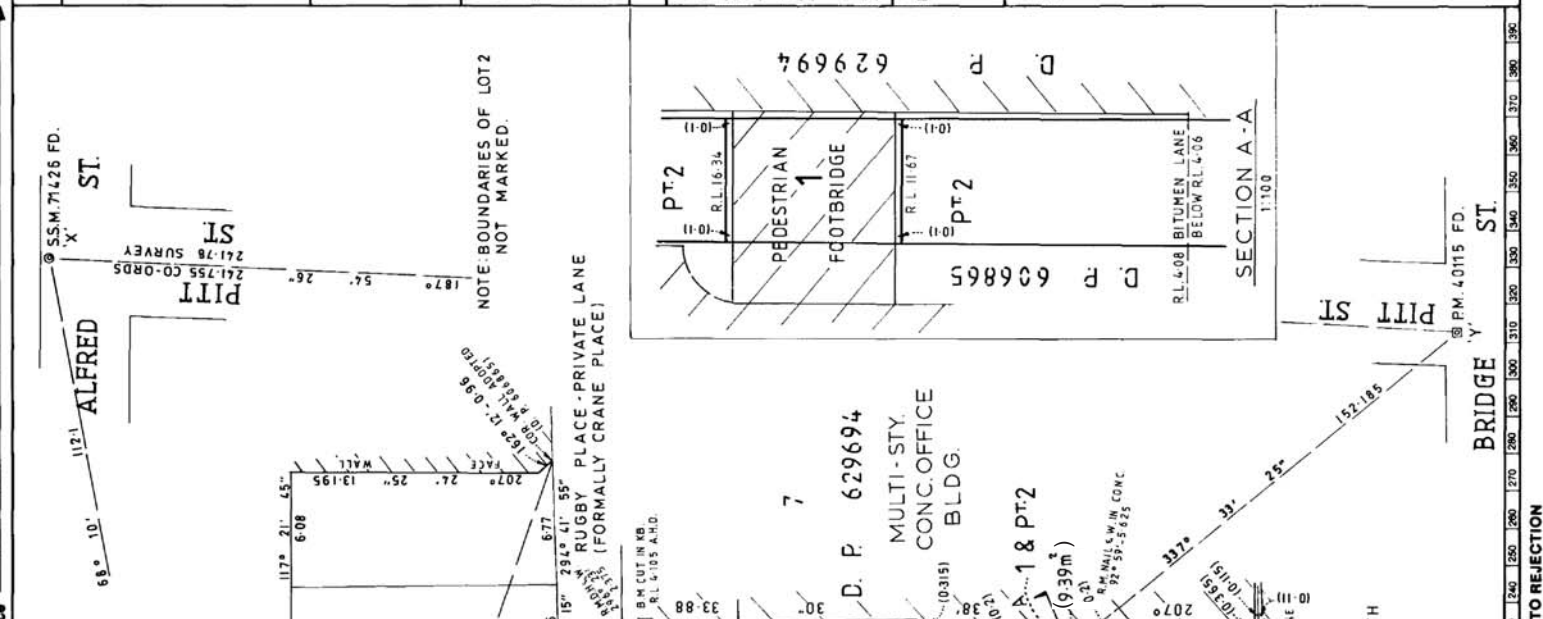

ALFRED ST  
 PITTS SURVEY 221.78 CO-ORDS  
 S.S.M. 71426 FD.

NOTE: BOUNDARIES OF LOT 2 NOT MARKED.

NOTE: THE STRUTUM OF LOT 1 IS LIMITED IN HEIGHT & DEPTH TO THE LEVEL PLANES SHOWN IN SECTION A-A

WARNING: CREASING OR FOLDING WILL LEAD TO REJECTION